

EXHIBIT 1



SHERIDAN ROAD
PROPERTY

WINTHROP
HARBOR



SITE LOCATION



SECTION 3
TOWNSHIP 46 N
RANGE 12 E

DATE: 1993



SCALE:
1" = 2000'

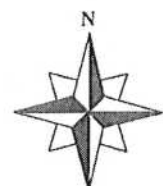

I:\05000+1\05068 Sheridan Road - Winthrop Harbor - RevertWorking\Ecology\05068_2009-Definitive-Report_Lake-County.dwg (2) LCM1 6/4/2009 7:47:34 AM

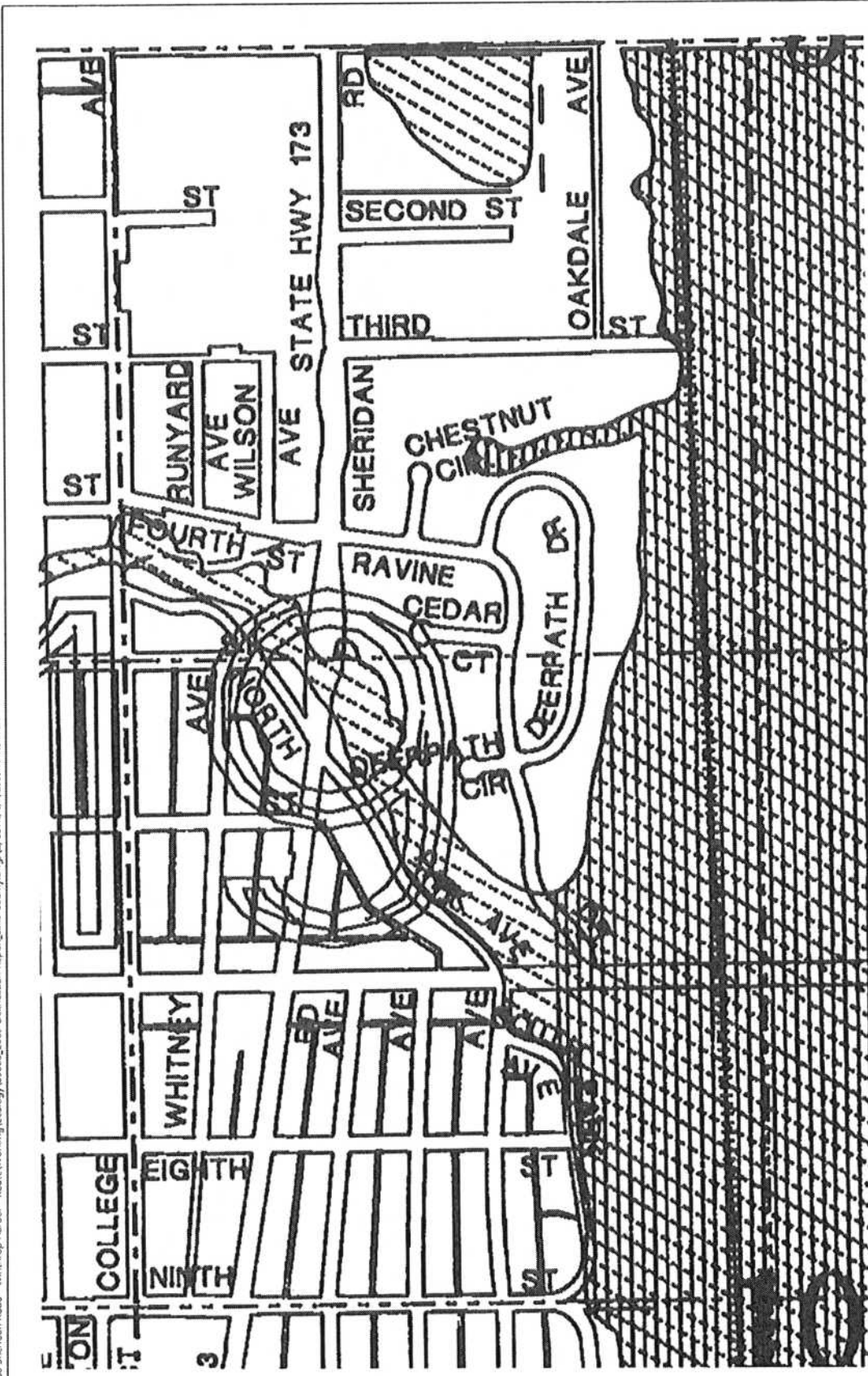

EXHIBIT 2



SHERIDAN ROAD
PROPERTY

WINTHROP
HARBOR



LAKE COUNTY
WETLAND
INVENTORY



TOWNSHIP NAME:
BENTON-ZION

DATE: 1993



SCALE:
1" = 400'



EXHIBIT 3



SHERIDAN ROAD
PROPERTY

WINTHROP
HARBOR



ESTIMATED
WETLAND
BOUNDARIES ON
AERIAL
PHOTOGRAPH



DATE OF PHOTO:
2007



SCALE:
1" = 200'

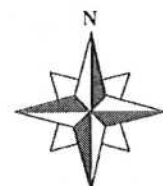

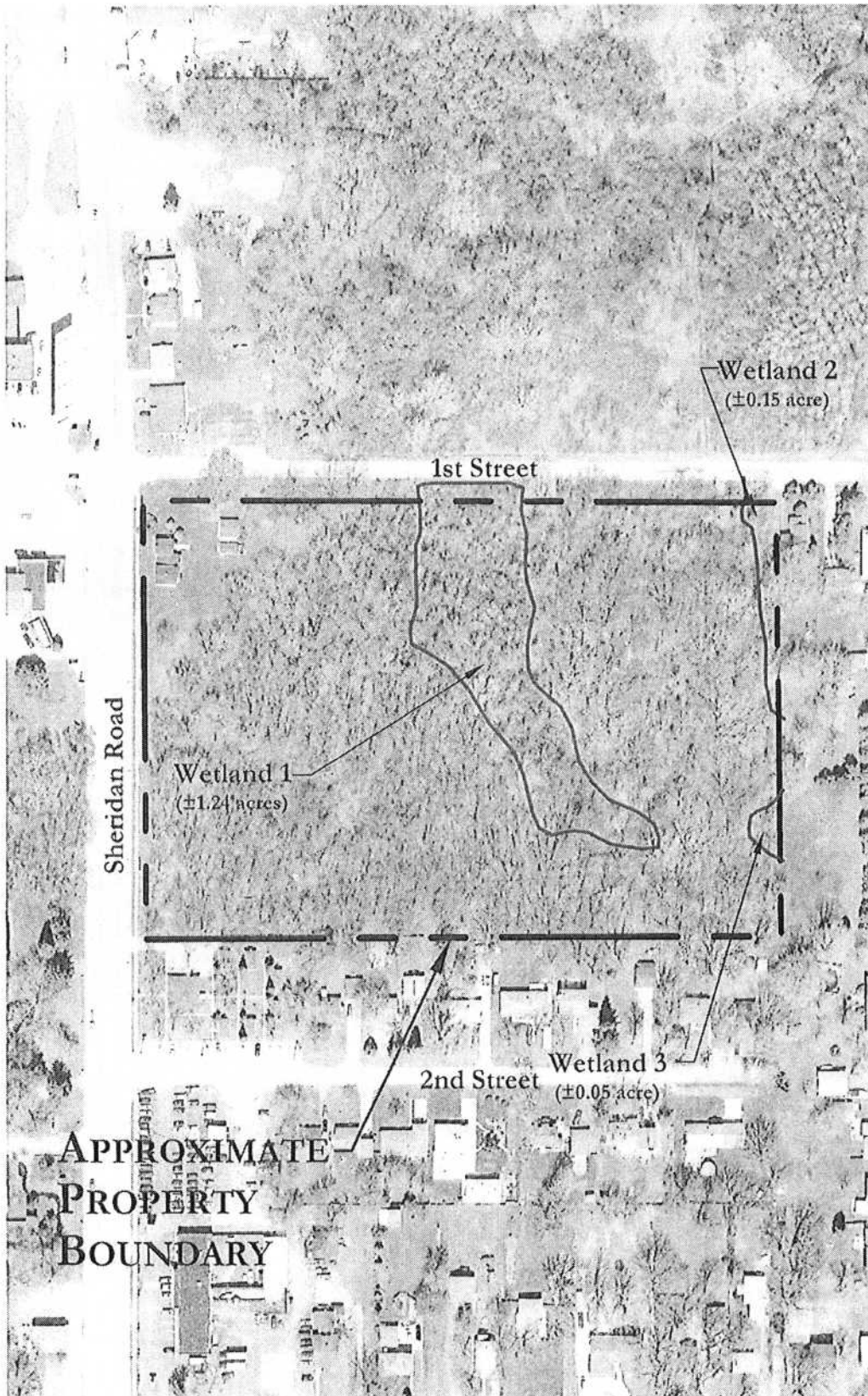

I:\09000+09568 Sheridan Road - Winthrop Harbor - Roate\Working\Ecology\09068_2009-Delineation-Report_Lake-County.dwg, [E] Aerial, 6/4/2009 7:47:51 AM

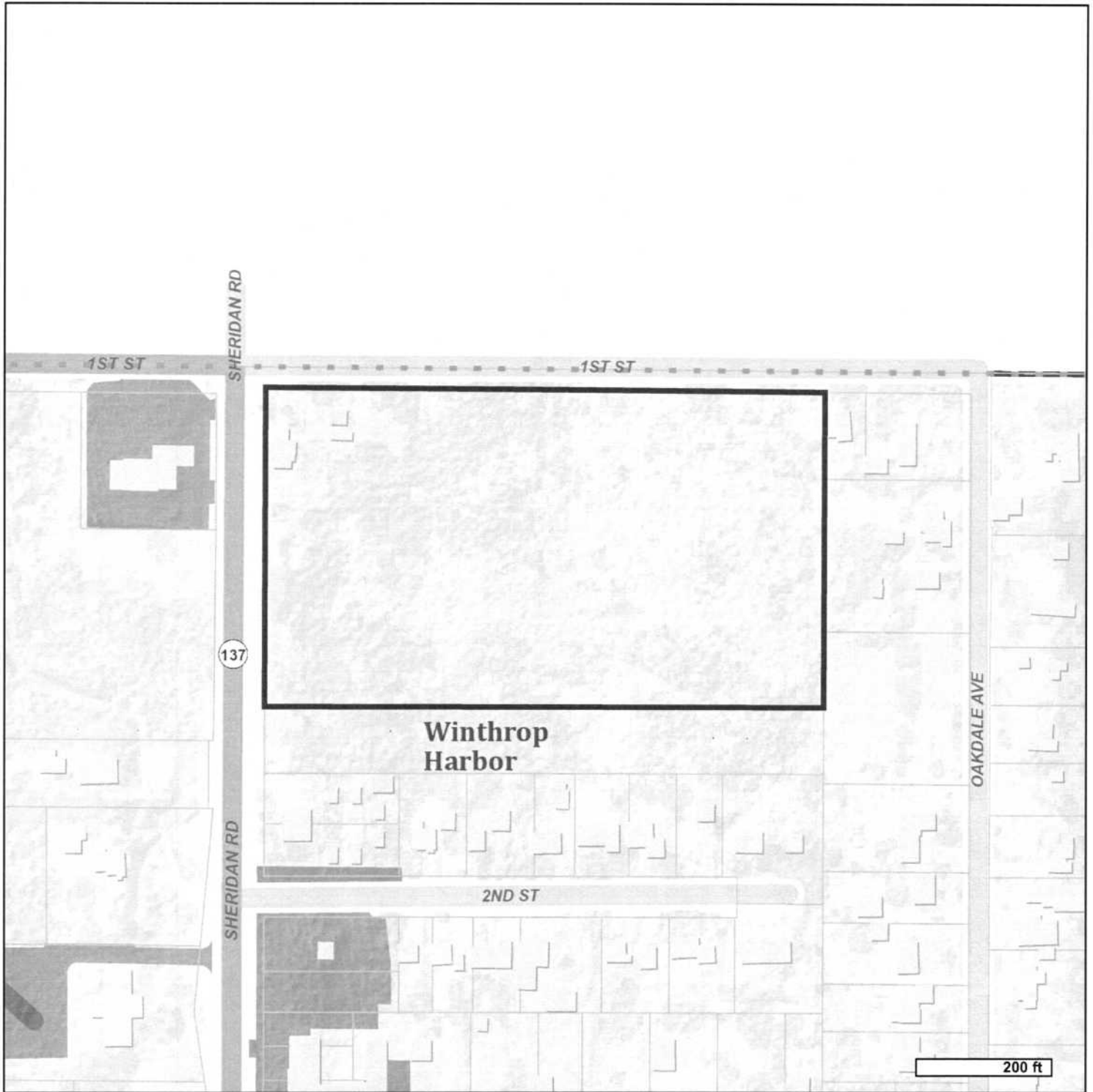

APPROXIMATE
PROPERTY
BOUNDARY

Lake County, Illinois











 **LakeCounty**
Geographic Information System

Lake County Department
of Information Technology
18 N County St
Waukegan IL 60085
(847) 377-2373

Map Printed on 09/13/2013
Parcel 0403300013 is outlined.

 N

-  2011 Buildings
-  Lake County Border
-  Water
-  Municipalities
-  Tax Parcels
-  Parks
-  Railroads
-  Trails

Disclaimer

The selected soil feature layer may not occur anywhere in the current map extent. A Registered Land Surveyor should be consulted to determine the precise location of property boundaries on the ground. This map does not constitute a regulatory determination and is not a base for engineering design. This map is intended to be viewed and printed in color.